



NO WAITING CONE

ROAD CONES

Available as a triangular Warden Cone and Conical Cone. The top is made with a flexible compound and the base is 100% recycled plastic. Ideal for parking control at events and is a popular police cone.

PRODUCT RANGE



NO WAITING CONE

Usage Benefits

- ▶ Can be easily installed, transported and stored
- ▶ Can clearly and easily demarcate areas of road, walkways and work sites
- ▶ Visible demarcation to prevent idling and parking in restricted areas
- ▶ 2 part cone with durable recycled PVC base, outlasts 1 part cone alternatives

NO WAITING CONE WARDEN

Product No.	O9200
Width	400mm
Length	365mm
Height	550mm
Weight	3.6kg
Quantity / Pallet	200
Colour	Yellow

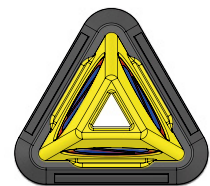
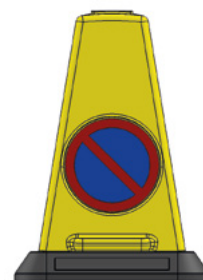

NO WAITING CONE CONICAL

Product No.	O9205
Width	285mm
Length	285mm
Height	500mm
Weight	2.5kg
Quantity / Pallet	400
Colour	Yellow

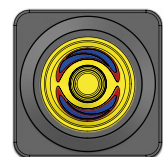

COMPLIANCE CODES

Safety at Street Works and Road Works (Red Book), Traffic Signs Manual (Chapter 8), BS EN 13422:2019, TSRGD 2015